

# 5.4 Key Places and Spaces

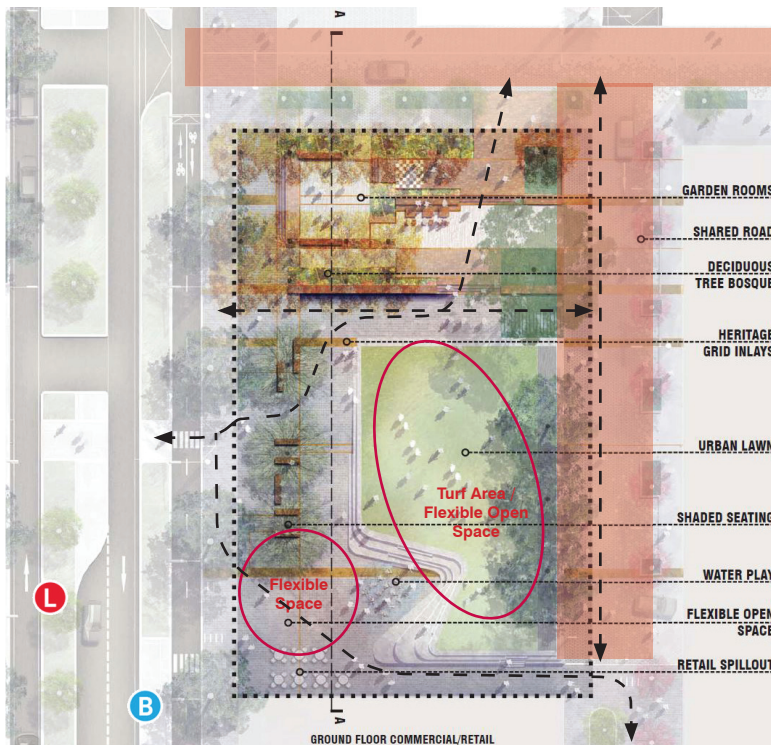

Dyuralya Square can be defined as the civic square and 'heart' of Lachlan. The urban space will serve to complement the transport corridor of Gadigal Avenue and form a contrast to the local green parks of The Rope Walk and a Wulaba Park.

It will be a place of local activity that features temporary small events, open lawn, incidental play and garden rooms for relaxation. The Square fronts onto a ground floor retail/non-residential uses that allow for a cafe or restaurant.

The design incorporates the rich historical context of the fine grain terrace housing that populated the area north of the square. This has been reinterpreted into what is now called the 'garden rooms' which mirror the arrangement and allude to how people once lived.

Historically the construction of the terraced houses was prevented to the South as this was the edge of the Waterloo Swamp. The swamp was later drained and warehouses and factories dominated the area. These historical overlays have influenced the design by including a water play element at the location of the swamp edge. The arrangement of furniture and open spaces is guided by the old factory alignments, depicted as inlays within the paving. These new spaces allow for the residents of Lachlan to congregate and enjoy community events.









## Objectives

- Establish a Neighbourhood Square as a focal public space that foster community activities such as; markets, community events, performance space, active play and passive recreation.
- Flexible multi-use space that future proofs activities for different times of the day. These could include such as stalls, food trucks, small bands and temporary art exhibitions.
- A space that encourage social interactions and serve as a meeting point for the Lachlan neighbourhood.
- Incorporation of surrounding streetscape and shareways that blend with the design of the square.
- Future light rail infrastructure spill out areas are accomodated and located on Gadigal Avenue.
- Quiet reflection spaces that maximise winter sun and summer shade.
- A design that fosters community engagement with the local environment and the site's rich history.
- Achieve Water Sensitive Urban Design outcomes by providing localised storm water collection, storage and display.
- Ensure safe and direct pedestrian desire lines through the park.
- Establish a robust and resilient park that caters for everyday use and activities.
- Provide equal access to all facilities and accessible gradients to all streets, pedestrian paths and through site links.

## Design Considerations

- Opportunities exist to include:
- a. Water Play facilities.
  - b. Community focused seating.
  - c. Variety of formal and informal seating options.
  - d. Materials that reflect sites history.
  - e. Lighting for night time activities.
  - f. Native and indigenous planting to 60% of plant species.
  - g. Turfed area for lounging and soaking up the suns rays.
  - h. Multipurpose space for community events and activities.
  - i. Water faucets.
  - j. 3- phase power in amenity block for community events.

## Key Principles

-  Meeting place with flexible community space for activities
-  Integration of shared way to form an extension to the square
-  Future Light Rail Stop,
-  Bus Stop
-  Landmark trees and seasonal groves allow for seating for different times of the day.
-  Provide formal and informal play facilities.
-  Facilitate pedestrian desire lines across square.
-  Interpretation of materials, design forms is playful and references the history of the place and gives a distinctive character.

Opportunities for Retail activity south of the square

Dyuralya Square provides spill out areas for future transport connection.

# Dyuralya Square



from top left 1 Water Play elements (Oculus). 2 Cafe seating fronting on to square (Oculus). 3 Informal Seating arrangements on raised turfed area (GallagherStudio). 4 Intimate detail design that reflects sites history (Oculus). 5 Native planting (COS). 6 Shared way (Jan Gehl). 7 Dynamic seated edge for a variety of seating options (Oculus). 8 Meeting and gathering spaces (unknown ref). 9 Square Dancing seen in Guangzhou China (Guangming Online). 10 Food stalls and food trucks (allhonesty.com).

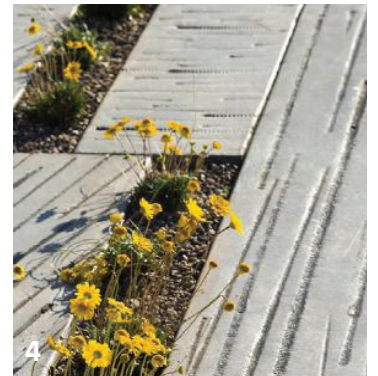

# 5.5 Key Places and Spaces |

The Rope Walk is a linear park system that stretches from Lachlan Street to O’dea Avenue on the western side of the Lachlan Precinct. Its location allows the park to become a green corridor through the precinct from the main thoroughfare of Joynton Avenue.

The linear park serves as not only a pedestrian connection but a habitat connection as well. Opportunities for strong visual links from the south, extends into Joynton Avenue. This is framed by a row of existing Fig trees, which have been extended into the planting of the park. A line of Jacarandas aids this visual link that guides viewers through the parks and provides a strong seasonal display.



The linear park is broken by Archibald Avenue to the north and a pedestrian through site link from Sam Sing Street to Dunkerley Place. These constraints have provided opportunities for programed park rooms. Within these ‘rooms’, are open spaces that are positioned in the sunniest sections of the park. The ‘rooms’ feature playgrounds, run around turf spaces for ball games and off leash areas for dog owners. These clearly divided spaces allows for the provision of flat open spaces which is achieved by level changes within planting beds.

Throughout the design, season flower gardens with tree lined paths guide you to an array of seating arrangements of benches and picnic tables. Deciduous trees provide autumn colour and solar access in winter.

For more direct path through the park a boardwalk to the west and a foot path to the east clearly separate the park and building frontages whilst providing a path of travel north and south.



# The Rope Walk

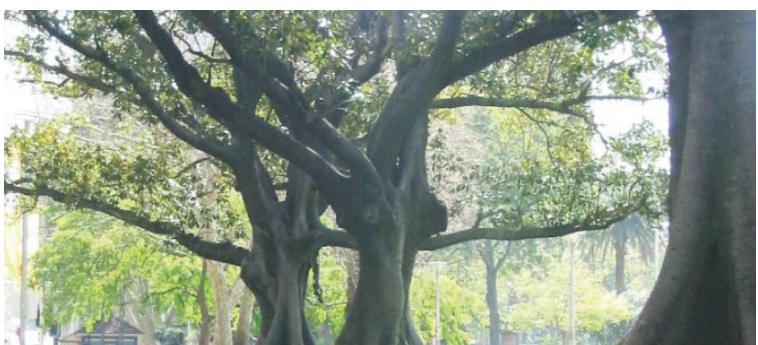
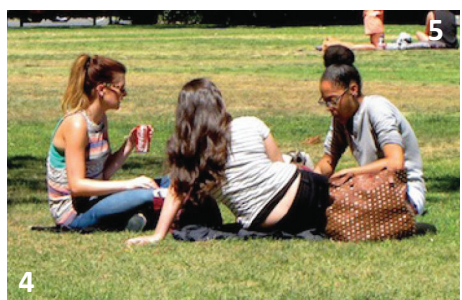
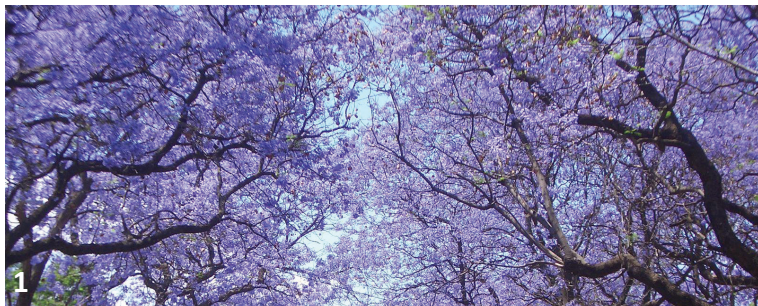

from top: 1 Seasonal Trees, 2,4 places for picnics, 3 Garden Seating, 5 Statement feature trees, 6 dog exercise areas, 7 toddler play grounds.(Source Gallagher Studios)

## Objectives

- Establish The Rope Walk as a consistent continuous linear park that connects all different types of activities
- Create a variety of spaces that are safe, legible, active and pedestrian oriented.
- Create a landscape corridor that is well defined
- Create inventive play spaces for children that incorporate natural playful elements.
- Provides a North / South deciduous tree canopy for solar access.
- Provide quiet reflection spaces that encourage long stay passive recreation.
- Allow for incidental play by providing items, materials and spaces that are interesting and exciting that encourage curiosity.
- Provide play spaces for younger and older children.
- Incorporate the sites rich history with in design that features throughout the park.

## Design Considerations

- Interpret local environment through influences such as past occupants of the site, natural history and landform, past uses, location and climate.
- Maximise variety of understory plant mixes to ensure long term success and the local ecological community.
- Use 60% of native planting for indigenous fauna
- Incorporate playful or art elements that provide interest and adds to the character of the neighbourhood.
- Provide areas to encourage a variety of social seating zones.
- All areas including all points of interest to have wheelchair access.
- Extension of the Joynton Avenue Fig Trees into park planting palette.
- Provide season trees for floral display, winter sun and summer shade.

## Key Principles

- Meeting place & Nodes of activity
  - ⓑ Nearby Bus Stop
  - ↔ Pedestrian desire line & through site link
- Interpretation of materials and design forms are playful that references the history of the place and gives a distinctive character.
- Opportunities for Retail activity south of the the park
- Landmark trees and seasonal groves allow for seating for different times of the day.
- Provide formal and informal play facilities.
- Provide dog facilities

# 5.6 Key Places and Spaces |

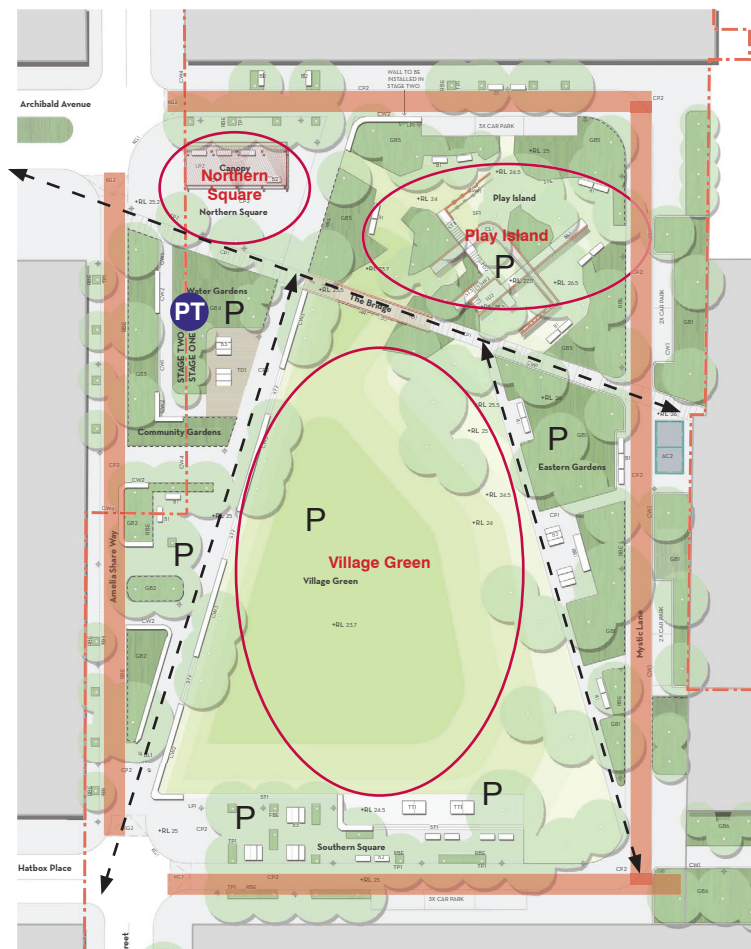

Wulaba Park is situated in the south-eastern corner of the Lachlan Precinct. The park incorporates a shared way on all sides that includes such streets as Archibald Ave, Amelia Street, Mystic Lane and Hatbox Place.

Wulaba Park is seen as the village green for the Lachlan Precinct that serves to create distinctive and memorable spaces. Facilities and attractions include gathering spaces, picnic tables, BBQs and public artworks feature within the park.

A focus on play for all ages is emphasised through flexible programed activities. Ping pong tables, ball courts and flexible open spaces allows for tai chi, square dancing and exercising classes.

'The Play Island' enhances imagination for children that provides a narrative to aid in play. Custom and off the shelf elements have been used, that includes fort, swings, ropes, cables, climbing nets, slides and tunnels. These elements have been incorporated into creative planting techniques and landform manipulation.





## Objectives

- Establish a 'Village Green' as a key community space between for the Lachlan Precinct.
- To design safe and attractive shared way this is integrate within the design of the park.
- To utilise the best solar access using deciduous trees for summer shade and winter sun.
- To provide screening for surrounding residential buildings while also allowing for passive surveillance and sight lines.
- areas for general ball games or running around spaces.
- Foster community engagement and understanding with local environments and the site's history.
- Establish a robust and resilient park that caters for everyday use and activities.
- Provide equal access to all facilities and accessible gradients to all streets, pedestrian paths and through site links.

## Design Considerations

- Play & exercise equipment.
- Community gardens.
- Community seating and tables
- Variety of formal and informal seating options
- Maximise permeable surfaces
- Consideration of materials life cycle and embodied energy
- Native and indigenous planting to 60% of planting species
- Amenity block
- BBQs
- 3- phase power in amenity block for community events.
- combination of evergreen and deciduous trees.
- textural species & seasonal interest in floral displays and autumn colours for understory planting as well as tree species.
- Incorporation of public artwork that is integrated into elements of the park.

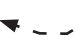
## Key Principles

-  Meeting places & Nodes of Activity
-  Integration of shared way to form an part of the park
-  Amenity Block
-  Facilitate pedestrian desire lines across the park.
-  Landmark trees and seasonal groves allow for seating for different times of the day.
-  Provide formal and informal play facilities.

# Wulaba Park



from top left 1 Deciduous Tree lined paths for summer shade and winter sun (Gallagher Studio). 2 incidental play through WSUD planting (COS). 3,7 adventure play (Gallagher Studio). 4. Public Art, West 8. 5 Shared Zone, Jan Gehl. 6 targeted play activities (Kinneer LA). 8 Community Gardens, Newtown.

